

# utilitylab

STUDIO GALLERY (2026)

---



# utilitylab

STUDIO GALLERY (2026)

---



STUDIO I 2,310 SF

# utilitylab

STUDIO GALLERY (2026)

---



MEDIA LOUNGE | DAY



MEDIA LOUNGE | NITE

# utilitylab

STUDIO GALLERY (2026)

---



CLIENT AREA | DAY



CLIENT AREA | NITE

# utilitylab

STUDIO GALLERY (2026)

---



FLEX AREA | DAY



FLEX AREA | NITE

# utilitylab

STUDIO GALLERY (2026)

---



GRIP & ELECTRIC

# utilitylab

STUDIO GALLERY (2026)

---



COLOR & FINISH

# utilitylab

## STUDIO SPECIFICATIONS (2026)

### STUDIO

- 2,310 Square Feet
- 14' Ceilings w/ Lighting Grid
- 10' Pocket Doors
- Polished Matte Concrete Floors
- Motorized Blackout Shades
- Dedicated 200 AMP 3-Phase
- Full Kitchen + Washer/Dryer
- Client Area + Media Lounge
- PATH Train Accessible
- Free Parking
- Loading Dock
- Freight Elevator

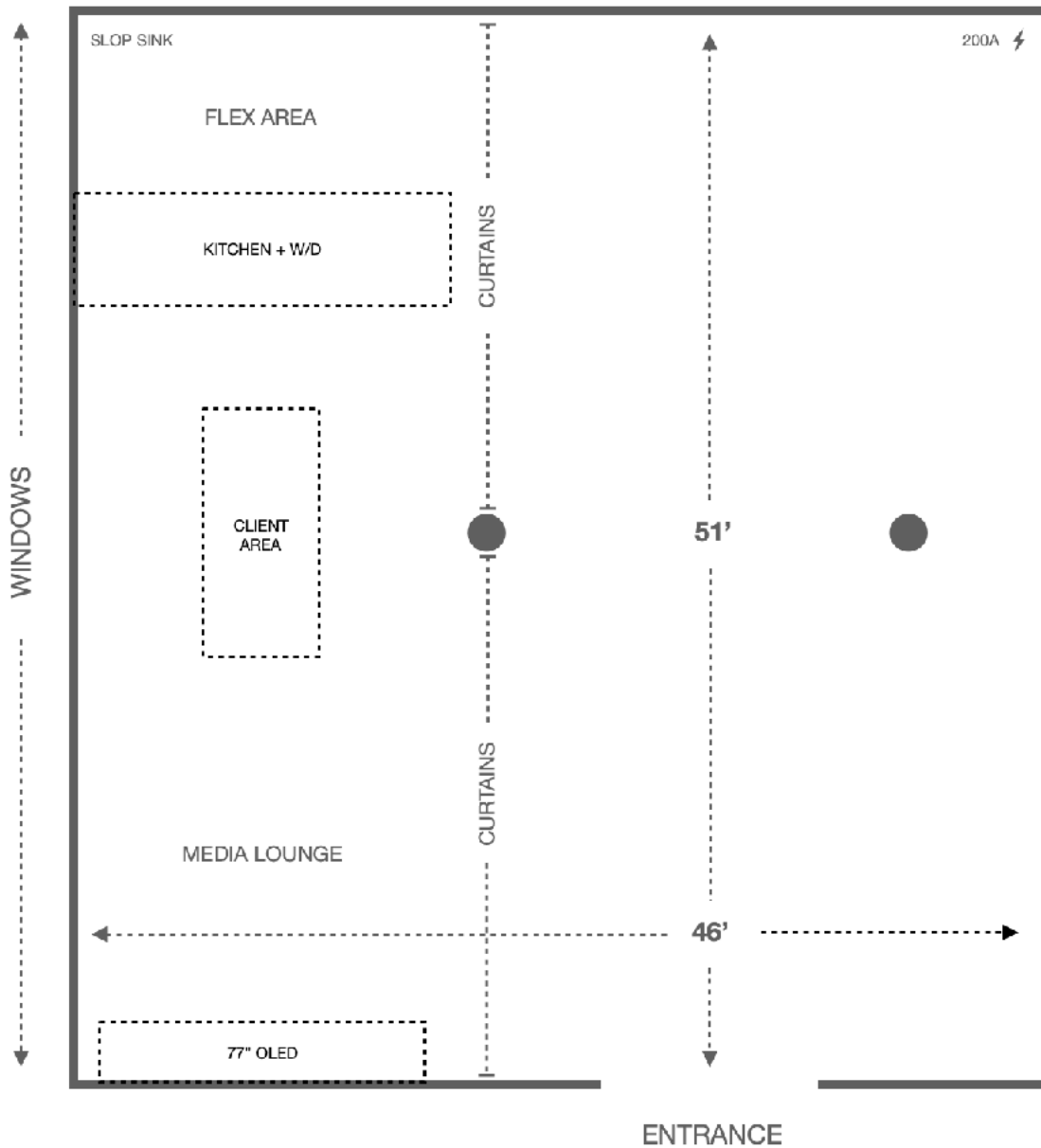

# utilitylab

## STUDIO SPECIFICATIONS (2026)

---

### PRODUCTION SUPPLIES

- (8) Folding Tables
- (2) Eco-Flow River Portable Batteries
- (1) Brother Monochrome Printer
- (1) Sonos Surround Sound System
- (1) Jiffy Steamer
- (4) Commercial Food Heat Lamps
- (2) Commercial Soup Warmers
- (4) Chafing Dishes
- (24) Folding Chairs
- (2) 60x30 Rolling Tables
- (4) Portable Partitions (13' x 7.4')
- (1) Rolling Trash Bin w/ Trash Liners
- (2) Vanity Mirrors w/ Bulbs
- (2) Rolling Racks w/ Hangers
- (1) 2.5g Wet/Dry Shop Vac
- (1) Broom

### GRIP

- **Apple Boxes:**
  - (6) full, (4) half, (4) quarter, (6) pancake
- **Bags:**
  - (12) 25lb Shot Bags, (12) 15lb Shot Bags, (8) 8lb Shot Bags, (8) 8lb Boa Bags
- **Stands:**
  - (10) Avenger C-Stand (Turtle Base) w/ 40" Arm / Black
  - (10) Avenger C-Stand (Turtle Base) w/ 20" Arm / Black
  - (4) Avenger Combo Stand 11.5' / Black
  - (2) Avenger Low Boy 6.5' / Black
  - (2) Matthew's Minivator II Crank Stand - 142" / Black
  - (2) Matthews Medium Overhead Roller Stand (14', Black)
  - (2) Matthew's Monitor Stand II
- **Hardware:**
  - (24) #1 Clip, (24) #2 Clip, (12) #3 Clip
  - (4) Duckbills
  - (4) Jr. Spud Adapters, (2) 6" Pins w/ Collar
  - (2) 3" Pin Wall Plates, (2) 6" Pin Wall Plates, (2) Jr. Wall Plates
  - (4) 2" Cardellini, (2) 6" Cardellini, (2) Mini Mattheellini Clamp
  - (24) Grip Heads
  - (6) Mafer w/ Stud
  - (8) Furniture Clamps, (4) Mini Furniture Clamps
  - (1) Matthews Jr. Triple Header
  - (2) 90° Degree Jr. Adapter Vertical Mount
  - (1) Matthews Menace Arm Kit for 1 1/4 Speed Rail"

# utilitylab

## STUDIO SPECIFICATIONS (2026)

---

### GRIP - CONT'D

- **Square Stock & Accessories:**
  - (1) 8x8 Breakdown Frame, 4ft Square Tubes (w/ Set-Screws)
  - (8) 1" Square Stock, 6ft
  - (8) 1" Square Stock, 4ft
  - (4) 1" Square 3-Way Corners (Non-Pass Through / Set Screws)
  - (4) 1" Square Tube Sleeves (Set Screws)
- **Speed-Rail & Accessories):**
  - (4) 6ft Speed-Rail
  - (8) 4ft Speed-Rail
  - (8) 2ft Speed-Rail
  - (8) 1ft Speed-Rail
  - (12) Internal Couplers (for Speed-Rail)
  - (4) Swivel Cheeseboro Clamp, (4) Fixed Cheeseboro Clamp
- **Frames**
  - (2) 48x48 - 3/4" Square Aluminum Tube Gel Frame
  - (2) 36x36 - 3/4" Square Aluminum Tube Gel Frame
  - (2) 24x36 - 3/4" Square Aluminum Tube Gel Frame
- **Flags**
  - (2) 24x36 - Flag
- **Floppy**
  - (4) 48x48 - Floppy
- **Overheads**
  - (2) 8x8 Solid (duvetyne)
  - (1) 8x8 Ultrabounce (black/white)
  - (1) 8x8 Chroma-Key Green
  - (2) 8x8 Magic Cloth
  - (1) 8x12 Magic Cloth
- **Utility:**
  - (6) V-Flats (White / Black)
  - (4) Saw Horses
  - (12) Ratchet Straps
  - (1) 8ft Ladder, (1) 6ft Ladder, (1) 4ft Ladder
  - (1) Loaded Tool Chest
  - (12) Safety Mats
  - (12) 32" Safety Cable, (6) 41" Safety Cable
  - (1) Steel Utility Cart - 54 x 24 x 36"

# utilitylab

## STUDIO SPECIFICATIONS (2026)

---

### ELECTRIC

#### Distribution Boxes:

- (1) 200A 3-Phase / (6) 100A Bates Distro Box w/ Feed Thru Cam-Lock
- (2) 100A Lunchbox w/ Feed Thru Stage Pin
- (1) 400A / (6) 30A Nema L21-30 Distro Box

#### Power Cables:

- 5-Wire: (1) 25ft, (1) 6ft
- Bates: (2) 25ft
- Stingers: (4) 50ft, (8) 25ft, (8) 12ft

#### Power Accessories:

- (6) Powerstrips
- (24) Cubetaps

### LIGHTING

- (1) **Astera Titan Tube Kit** (3.4' Tubes x12 w/ AsteraBox CRMX Transmitter Box, iPad Mini)
- (2) **Aputure LS 1200d Pro LED Light Kit** (w/ Reflectors)
- (2) **Aputure LS 600d Pro Daylight LED Monolight** (w/ Reflectors + Barndoors)
- (1) **Aputure LS 60d Daylight LED Focusing Flood Light** (w/ Barndoors)
- (2) **Aputure Nova P300c RGB LED Light Panel** (w/ Softbox)
- (2) **Aputure STORM 1200x Tunable White LED Monolight** (w/ Reflectors + Barndoors)
- (2) **Aputure STORM 700x Tunable White LED Monolight** (w/ Reflectors)
- (4) **Aputure STORM 400x Tunable White LED Monolight** (w/ Reflectors)
- (1) **Aputure STORM 1000c BLAIR-CG LED Monolight** (w/ Wide Reflector)
- (5) **Aputure STORM 80c BLAIR-CG LED Monolight** (w/ Reflector)

### MACHINERY

#### Man-Lifts:

- (1) Genie GR-12
- (1) Genie AWP-20s

### MRMC - BOLT HIGH-SPEED CINEBOT (ON PEDESTAL)

The Bolt™ High-Speed Camera Robot is the fastest of its kind – capturing images in crisp focus that would be impossible by hand or any other method. The precision cinema robot adds an entirely new perspective to filming.

The Bolt camera robot moves from standstill to full high-speed motion and back to a complete stop in fractions of a second – capturing the fastest action with pinpoint accuracy. The precision robotic arm is capable of horizontal and vertical movement speeds of up to 2 meters per second, and 180-degrees of rotation in 1 second.

- Maximum Height: 11' 5"
- Lowest Position: 0'
- Maximum Reach (from center of rotation): 6' 6"
- Weight: 1,323lbs
- Max Payload: 44lbs
- Power Requirements: 32A / 3-Phase Power



### **MRMC - BOLT MINI MODEL MOVER**

The Bolt™ Mini Model Mover is an extremely versatile lightweight 6-axis high-speed arm capable of full manipulation of products with repeat pass precision, timing and triggering capabilities.

The Bolt Mini Model Mover can be used as a standalone system or synchronized with a camera shooting bot and enables full manipulation of products with repeat pass precision, timing and triggering capabilities. The model mover comes with several mount options, including chuck mount and cheese plate giving users a wide range of capture possibilities.

- Maximum Reach (from center of rotation): 3' 3"
- Weight: 93lbs
- Max Payload: 17lbs
- Power Requirements: 200-230V AC Single Phase

